

YOUR DRAINAGE SPECIALIST



BLÜCHER®

KEEPING UP THE FLOW

STAINLESS STEEL DRAINAGE SYSTEMS

Product range

■ Type: 820 - 87,5° bend

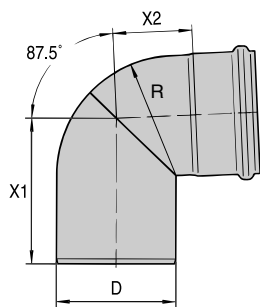

Type No.	D	X1	X2	R
820.090.050	50	86	40	50
820.090.075	75	107	53	75
820.090.082	82	109	53	82
820.090.110	110	134	73	110
820.090.125	125	158	93	125
820.090.160	160	181	105	171
820.090.200 S	200	397	307	400

■ Type: 820 - 45° bend

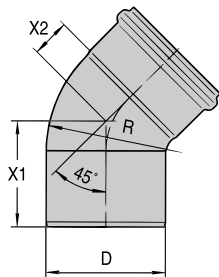

Type No.	D	X1	X2	R
820.045.050	50	60	26	50
820.045.075	75	76	33	75
820.045.082	82	80	30	82
820.045.110	110	93	43	110
820.045.125	125	113	39	125
820.045.160	160	131	55	182
820.045.200 S	200	234	144	400

■ Type: 820 - 30° bend

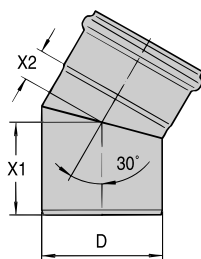

Type No.	D	X1	X2
820.030.050	50	57	16
820.030.075	75	71	21
820.030.082	82	70	23
820.030.110	110	85	28
820.030.125	125	98	28
820.030.160	160	110	40
820.030.200 S	200	137	45

■ Type: 820 - 15° bend

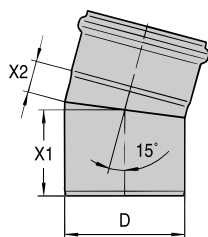

Type No.	D	X1	X2
820.015.050	50	54	12
820.015.075	75	66	16
820.015.082	82	64	17
820.015.110	110	78	21
820.015.125	125	84	19
820.015.160	160	99	29
820.015.200 S	200	123	31

■ Type: 825 - 87,5° Long radius bend

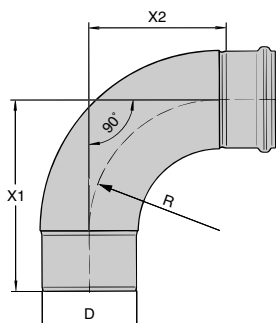

Type No.	D	X1	X2	R
825.090.050	50	125	77	70
825.090.075	75	155	105	95
825.090.110	110	222	160	152
825.090.160	160	322	247	229

Product range

■ Type: 838 - 45° Oblique branch

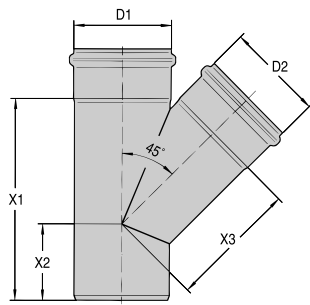

Type No.	D1	D2	X1	X2	X3
838.050.050	50	50	128	57	76
838.050.075	75	50	144	56	94
838.050.082	82	50	149	57	102
838.075.075	75	75	179	74	110
838.075.082	82	75	185	75	114
838.082.082	82	82	195	80	118
838.050.110	110	50	147	42	119
838.075.110	110	75	182	60	135
838.110.110	110	110	233	88	149
838.110.125	125	110	250	90	154
838.125.125	125	125	273	103	170
838.110.160	160	110	258	80	186
838.160.160	160	160	328	115	222
838.160.200 S	200	160	359	123	250
838.200.200 S	200	200	415	151	274

■ Type: 848 - 87.5° Swept branch

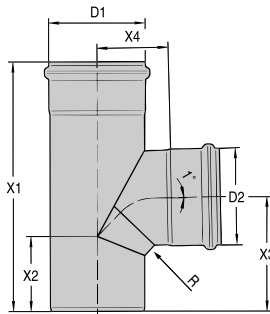

Type No.	D1	D2	X1	X2	X3	X4	R
848.050.050	50	50	170	60	81	46	9
848.050.075	75	50	194	57	94	62	15
848.050.110	110	50	209	47	103	80	16
848.075.075	75	75	229	75	127	86	53
848.075.110	110	75	239	58	114	86	25
848.110.110	110	110	290	88	138	86	20
848.110.160	160	110	306	84	164	114	27
848.160.160	160	160	358	115	184	122	38

Note: To comply with BS EN 12056 Sanitary Pipework, fittings can be special manufacture with R=50mm

■ Type: 839 - 87.5° Swept branch

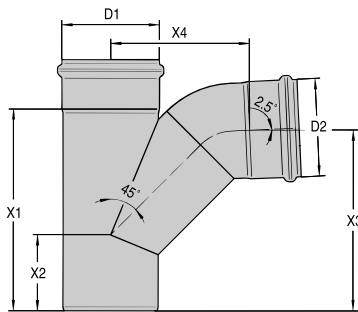

Type No.	D1	D2	X1	X2	X3	X4
839.050.050	50	50	128	57	117	84
839.050.075	75	50	144	56	128	97
839.075.075	75	75	179	74	157	113
839.050.110	110	50	147	42	132	115
839.075.110	110	75	182	60	160	130
839.110.110	110	110	233	88	209	160
839.110.160	160	110	258	80	227	186
839.160.160	160	160	328	115	293	225

■ Type: 879 - 87.5° Double branch 180°

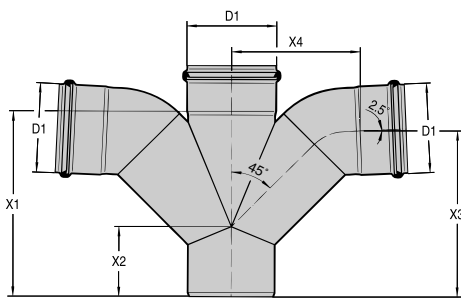

Type No.	D1	X1	X2	X3	X4
879.110.110 S	110	233	88	209	160

■ Type: Back to back soil manifold

→ See page 13 for more details

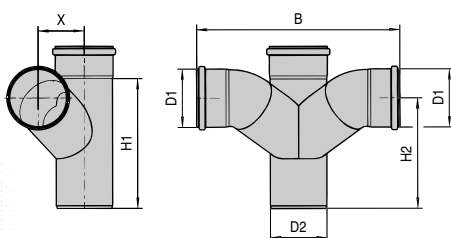

Type No.	D1	D2	H1	H2	B	X
879.110.110.01 S	110	110	253	215	396	45
879.110.110.02 S	110	110	253	215	396	60
879.110.110.03 S	110	110	253	215	396	75
879.110.110.04 S	110	110	253	215	396	90
879.110.110.05 S	110	110	253	215	396	105
879.110.110.06 S	110	110	253	215	396	120
879.110.110.07 S	110	110	253	215	396	135
879.110.110.08 S	110	110	253	215	396	150

Product range



■ Type: Waste manifold

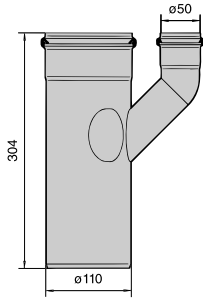
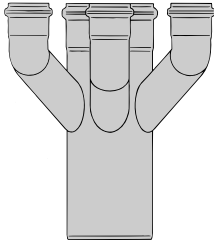

3 No 50 mm EuroPipe® connections.
Use 844.100.050.S blank plug for unwanted connections

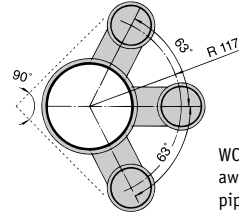

WC can be upto 5040 mm away from stack if soil pipe falls at 0.5 deg into a standard 839.110.110 soil branch

■ Type: 840 - Access pipe

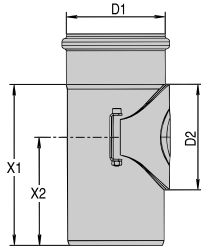

Type No.	D1	D2	X1	X2
840.075.075	75	83	139	92
840.110.110	110	120	188	117
840.111.110	110	120	253	187
840.125.125	125	120	195	128
840.160.160	160	120	277	208
840.200.200 S	200	120	289	208

■ Type: 841 - Double ring-seal socket

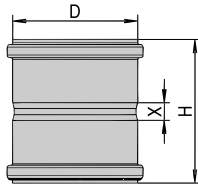

Type No.	D	H	X
841.050.050	50	97	13
841.075.075	75	120	20
841.082.082	82	124	20
841.110.110	110	130	16
841.125.125	125	140	20
841.160.160	160	162	20
841.200.200 S	200	200	20

■ Type: 842 - Sliding ring-seal socket

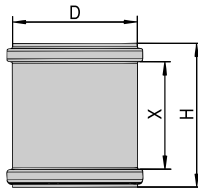

Type No.	D	H	X
842.050.050 S	50	97	71
842.075.075 S	75	120	91
842.082.082 S	82	124	95
842.110.110 S	110	130	97
842.125.125 S	125	140	104
842.160.160 S	160	162	118
842.200.200 S	200	200	147

■ Type: 869 - Retro Fit socket

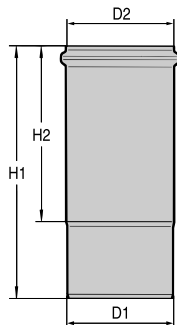

Type No.	D1	D2	H1	H2
869.143.050	50	51	200	143
869.163.075	75	76	225	163
869.170.082	82	83	240	170
869.181.110	110	111	260	181
869.200.125	125	126	300	200
869.238.160	160	161	360	238
869.300.200	200	201	420	300

Product range

■ Type: 844.000 - Socket plug

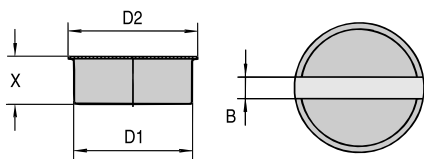

Type No.	D1	D2	X	B	Pressure
844.000.050 S	50	58	50	15	3 bar*
844.000.075 S	75	85	45	20	3 bar*
844.000.110 S	110	120	45	20	3 bar*
844.000.125 S	125	135	43	28	3 bar*
844.000.160 S	160	170	45	25	3 bar*
844.000.200 S	200	210	50	31	3 bar*

*When mounted with joint clamps type 847.xxx.xxx

■ Type: 844 - Socket plug

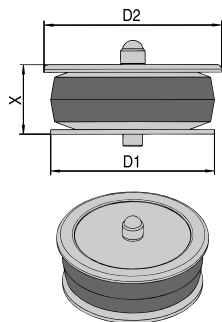

Type No.	D1	D2	X	Pressure
844.100.050 S	50	58	50	0.5 bar (2.0*)
844.100.075 S	75	85	45	0.5 bar (2.0*)
844.100.082 S	82	90	36	0.5 bar (2.0*)
844.100.110 S	110	120	45	0.5 bar (2.0*)

*When mounted with joint clamps type 847.xxx.xxx

■ Type: 847 - Joint clamp

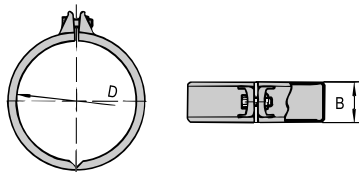

Type No.	D	B	Pressure
847.050.050	50	34	3.0 bar
847.075.075	75	34	3.0 bar
847.082.082	82	35	3.0 bar
847.110.110	110	36	2.0 bar
847.125.125	125	40	2.0 bar
847.160.160	160	46	1.0 bar
847.200.200	200	44	0.5 bar

Note! If pipe ends are dimpled then 3 bar throughout.
Can also be used for horizontal fixing and support, see page 14 and / or earth continuity, see page 26.

■ Type: 850 - Eccentric increaser

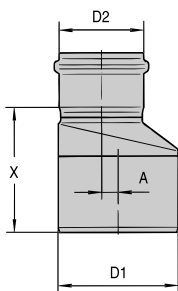

Type No.	D1	D2	X	A
850.050.075	75	50	87	7
850.050.082 S	82	50	97	14
850.050.110	110	50	113	25
850.075.082 S concentric	82	75	81	0
850.075.110	110	75	116	15
850.075.160	160	75	174	37
850.082.110 S	110	82	110	11
850.082.110 S concentric	110	82	110	0
850.110.125 S concentric	125	110	105	0
850.110.160	160	110	136	22
850.125.160 concentric	160	125	145	0
850.160.200 concentric	200	160	170	0

■ Type: 850 - Eccentric reducer

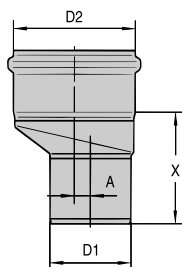

Type No.	D1	D2	X	A
850.075.050 S	50	75	84	7
850.110.050 S	50	110	99	25
850.110.075 S	75	110	103	15

Product range

■ Type: 525 - 87,5° P-trap

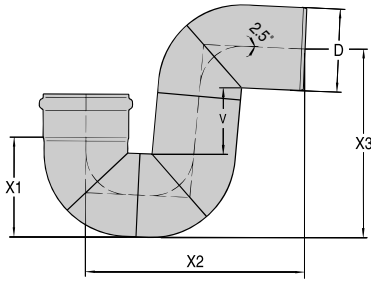

Type No.	D	X1	X2	X3	Water seal
525.090.050 S	50	67	175	145	74
525.090.075 S	75	93	222	189	81
525.090.110 S	110	132	289	249	89
525.090.125 S	125	151	314	277	110
525.090.160 S	160	184	388	338	105

Cleaning eyes available at extra cost.

■ Type: 851 - Sink connector

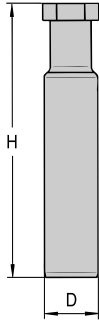

Type No.	D	H
851.025.040 S	50	254

With 1½" swivel nut.

■ Type: 640 - Vent cowl

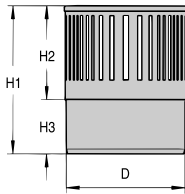

Type No.	D	H1	H2	H3
640.4118.2SP	110*	137	87	50

*Also available in 160 mm on request

■ Type: 891 - Rat stop

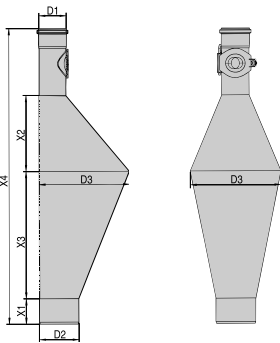

Type No.	D1	D2	D3	X1	X2	X3	X4
891.075.110 S	75	110	250	70	210	350	814
891.110.110 S	110	110	250	70	210	350	870
891.125.125 S	125	125	250	86	210	350	896

■ Below ground sealed access fittings

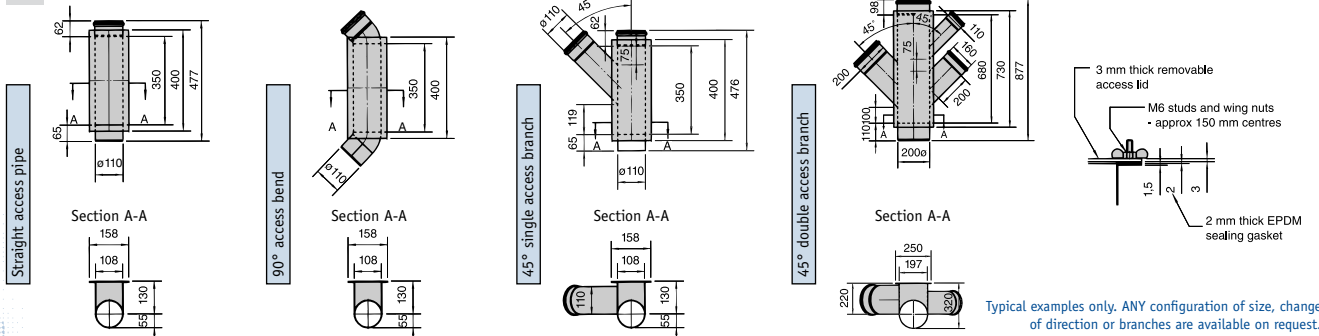

Typical examples only. ANY configuration of size, change of direction or branches are available on request.

All dimensions in mm - If Stainless Steel grade AISI 316L is required specify type no. with suffix S

Fixing and support



Galvanised steel pipe brackets

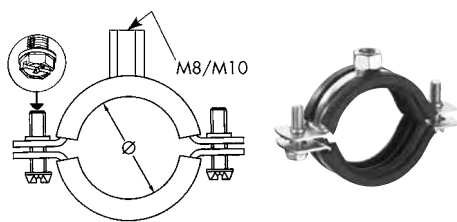

Type No.	Pipe dia.	Back Fixing Nut
595860	50	M8/M10
595890	75	M8/M10
595930	110	M8/M10
595940	125	M8/M10
595960	160	M8/M10
595971	200	M8/M10

1.5/2 mm thick with self threaded multifunctional M6 side fixing and EPDM sound insulating liner.

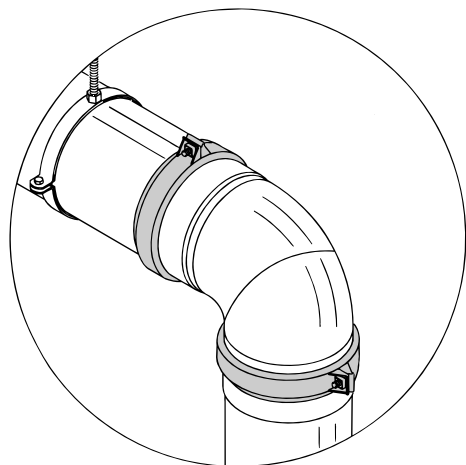

Pipe Joint Clamps Type No. 847. xxx.xxx S (see page 10) may be required if walls or soffits are not accessible for brackets.

Connection to other pipe materials

The BLÜCHER EuroPipe® system can be easily connected to other pipe materials, being either compatible or by using adaptors.

up to 600 mm



»TEEKAY« Couplers

Can be supplied for connecting our stainless steel pipe upto 600mm dia and/or for connection to other materials. Details on request.



»Flex-Seal« Couplers

PVC u

110/160/200

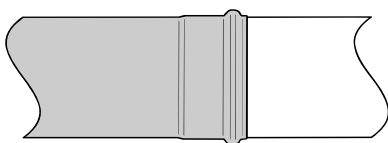

Compatible push-fit joint

54/82

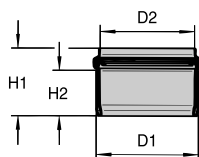

BLÜCHER stainless steel socket adaptor

Type No.	D1	D2	H1	H2
*852.050.054 SOS	54	50	49	30
852.075.082.SOS	82	75	60	40

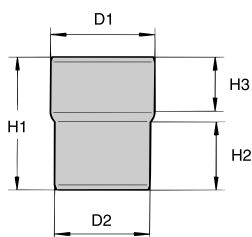

BLÜCHER stainless steel spigot adaptor

Type No.	D1	D2	H1	H2	H3
*852.050.054 S	54	50	97	49	38
852.075.082 S	82	75	123	63	50

*Note 2" PVCu waste to BS5254



OMC Technologies Ireland

Ballysimon Road,
Limerick,
Ireland

Tel. 061-419333

Fax: 061-418644

E-Mail: drainage@omc.ie



TECHNOLOGIES